

**Directions**

**Public transport**

From Zurich Main Station (HB) by S-train (S3, S9, S12) to Stettbach. From there about 20 minutes walk to Eawag (see map), or by tram No. 12 to "Am Ring" or by bus No. 760 to "Empa".  
 From Zurich Oerlikon by train S14 to Dübendorf and then by bus No. 760 to "Empa" or walk to Eawag, about 20 minutes (see map).  
 From Zurich-Airport by tram No. 12 to "Neugut" or "Am Ring" (about 20 minutes driving time).

**Car**

Motorway A1, exit Dübendorf, to the right towards Dübendorf, 300 meters after the major crossing turn left into the Eawag-Empa premises.

**Hotels near Eawag**

**HB** Hotel Bahnhof   **HZ** Hotel ZwiBack   **HS** Hotel Sonnental   **HH** Hotel Harry's Home



Eawag, Überlandstrasse 133, 8600 Dübendorf, Schweiz  
Telefon +41 58 765 55 11, [www.eawag.ch](http://www.eawag.ch)

Science that matters

**eawag**  
aquatic research ooo

EAWAG 3069 FC / B

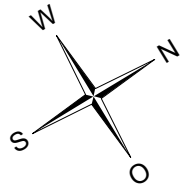
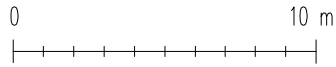

# Ground Floor

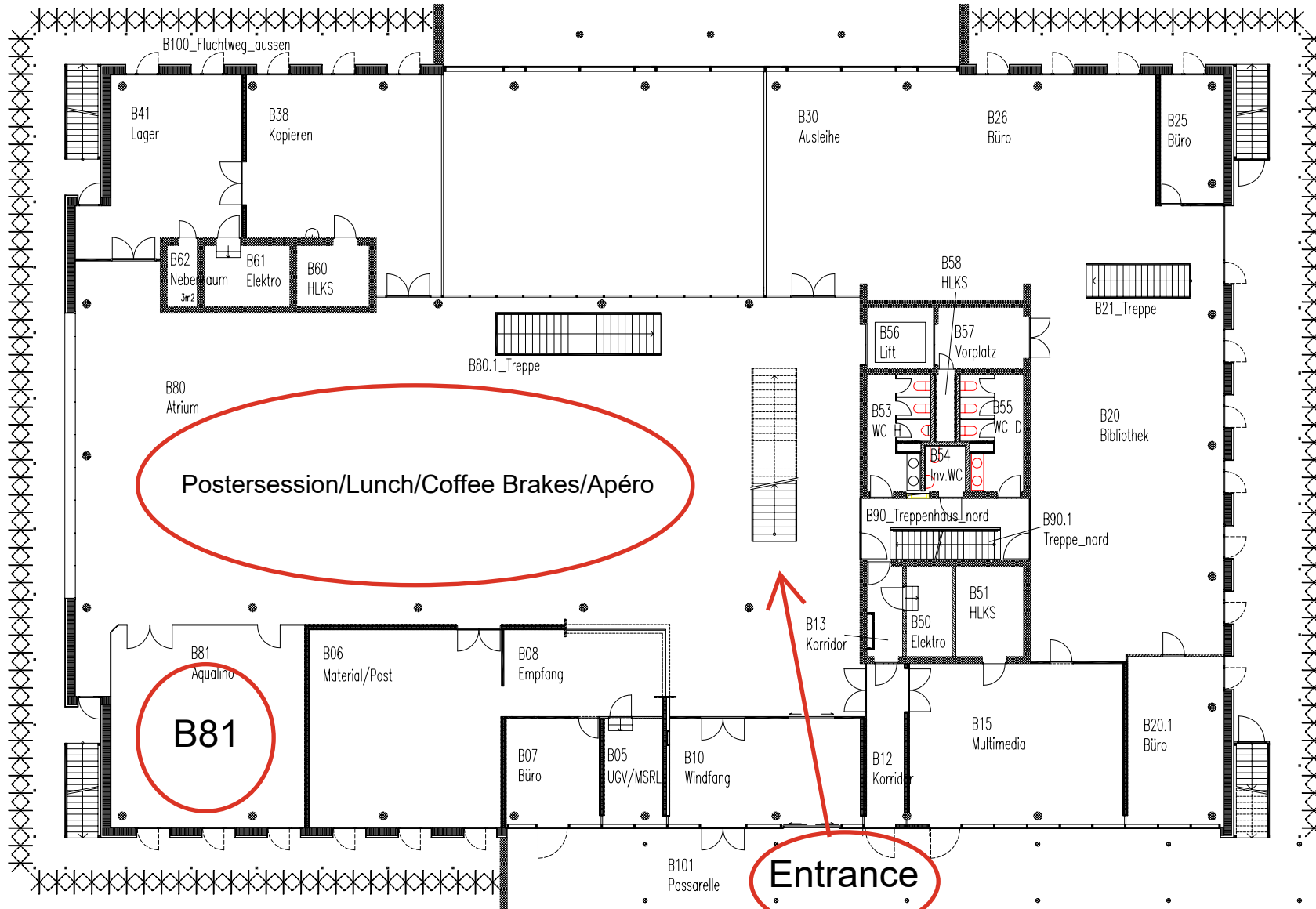

EAWAG 3069 FC / C

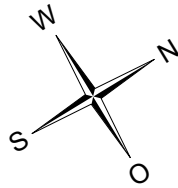
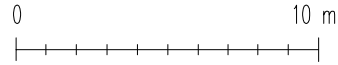

# First Floor

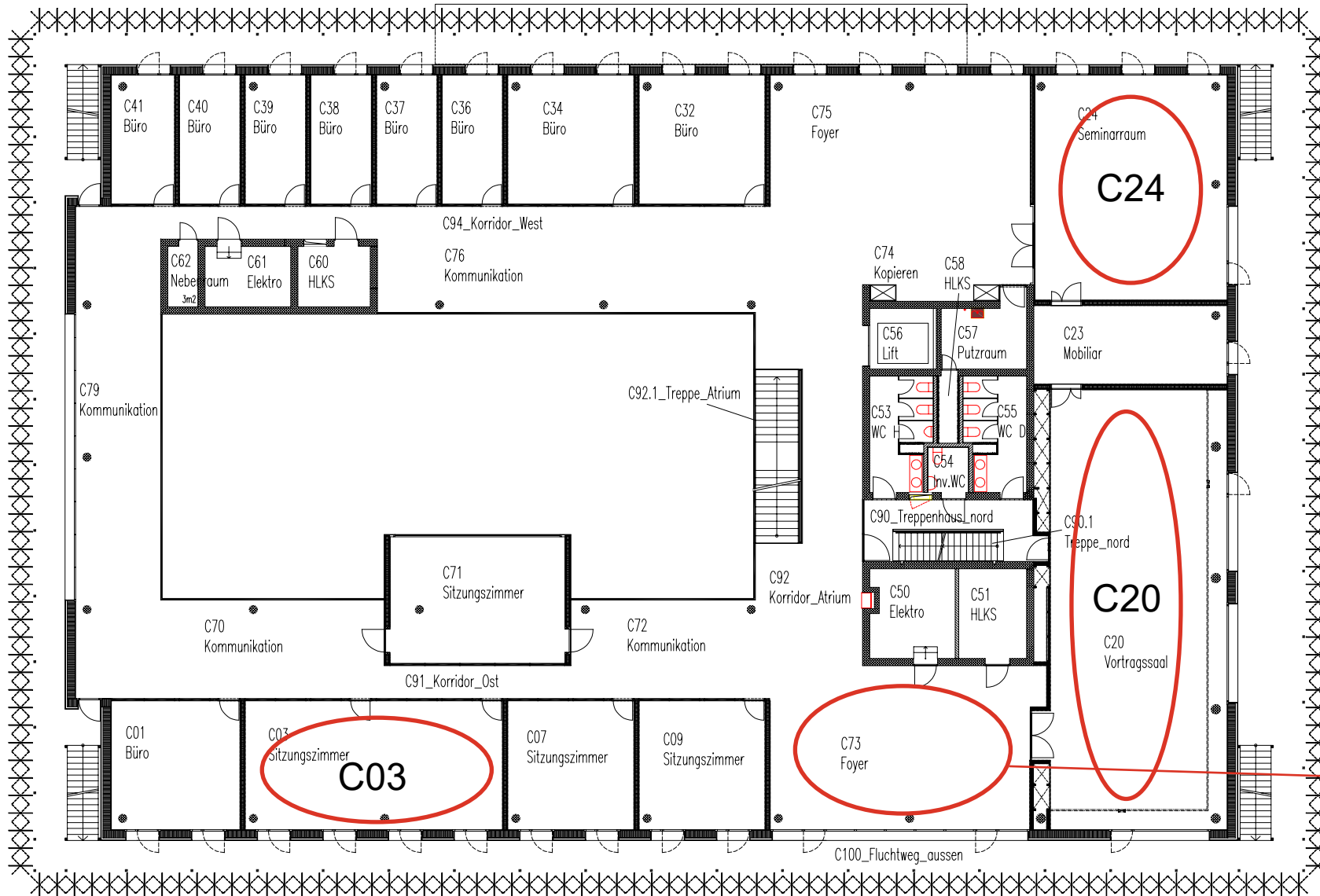

Conference  
Registration  
Desk

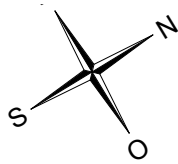

# Second Floor

